

Protos3 Software Installation Quick Guide

1 Start PC

➔ Log onto PC as an Administrator and shut all running software down

2 Insert the Synbiosis USB flash drive



➔ Browse to the flash drive in Windows, open the "Protos 3 (version*)" folder and then run the "Setup.exe" program.

* note: all new Protos 3 systems are shipped with the latest stable version of the Protos 3 software.

The PC may require a Windows update (particularly if the PC is Windows XP, Windows Vista or Windows 7). If you are presented with a message stating "This application needs Microsoft .Net Framework 4.0 full version which is not yet installed. This can be found in the Support directory.", then follow step 3, otherwise proceed to step 4.

3 Support folder

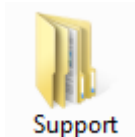

➔ Open the Support folder

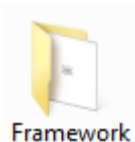

➔ Open the Framework folder



➔ Run SetupFramework.exe. Follow the on-screen instructions, performing a system restart if prompted



➔ Run Setup.exe once again and follow the on-screen instructions

Protos3 software utilises Microsoft's SQL Server. If this is not already present on the PC you will receive a message stating "This application requires SQL Server Express or SQL Express LocalDB, neither of which is yet installed on this computer. Do you wish to continue with the installation of Protos3 software (Press OK) or cancel and install a database engine?" If you already have a SQL server at a remote location press OK and go to step 5, otherwise press Cancel and follow step 4.

4 Install SQL Server

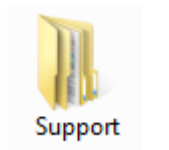

➔ Open the Support folder

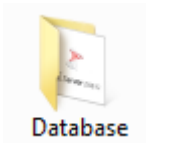

➔ Open the Database folder

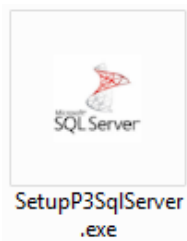

➔ Run SetupP3SqlServer.exe (see Protos SQL Installation QG for details within Installation -> Manuals-> Quick Guides) and perform a PC restart on completion

PLEASE NOTE: SQL LocalDB Express is designed for a single PC user. A single user should log onto the PC and, if there is more than one user running the Protos3 software, they should enter their details within the Protos3 software. **If more than one user is going to log onto Windows on the PC running Protos3 software, you should install, and use, SQL Server Express.**

5



Setup.exe

➔ Run Setup.exe once again and follow the on-screen instructions (see Protos3 Full Installation Guide for details within Installation -> Manuals-> Quick Guides)

6 Connect the Protos3

- ➔ Connect the power cord to the Protos3 and plug the unit in
- ➔ Connect the camera USB cable from the Protos3 unit to a spare USB port in the PC
- ➔ Switch on the Protos3 using the switch on the side of the unit

7 Adding users to SQL Server

The following steps need to be carried out when logged in as Administrator.

When Protos 3 is installed, a user's groups is created called Protos Users. Every user needs to be a member of this group.

Name	Description
Access Control Assist...	Members of this group can remotely query ...
Administrators	Administrators have complete and unrestrict...
Backup Operators	Backup Operators can override security restr...
Cryptographic Operat...	Members are authorized to perform cryptog...
Distributed COM Users	Members are allowed to launch, activate an...
Event Log Readers	Members of this group can read event logs ...
Guests	Guests have the same access as members of...
Hyper-V Administrators	Members of this group have complete and ...
IIS_IUSRS	Built-in group used by Internet Information ...
Network Configuratio...	Members in this group can have some admi...
Performance Log Users	Members of this group may schedule loggi...
Performance Monitor ...	Members of this group can access performa...
Power Users	Power Users are included for backwards co...
Remote Desktop Users	Members in this group are granted the right...
Remote Management...	Members of this group can access WMI res...
Replicator	Supports file replication in a domain
Users	Users are prevented from making accidental...
Protos Users	The administration group for Protos 3
SQLServer2005SQLBro...	Members in the group have the required ac...
SQLServerMSSQLServ...	Members in the group have the required ac...
SQLServerMSSQLUser...	Members in the group have the required ac...
SQLServerSQLAgentU...	Members in the group have the required ac...
WinRMRemoteWMIU...	Members of this group can access WMI res...

- ➔ From the Windows Control Panel select System and Security Administrative Tools then Computer Management
- ➔ Expand (+) local users and groups then click on Groups
- ➔ Right click on Protos Users and select Add to Group...

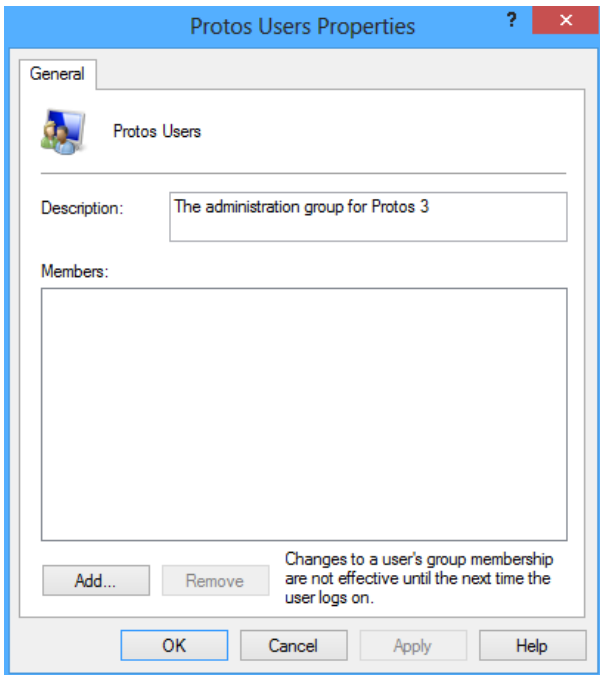

➔ Click Add to Group to add users

➔ Click Add

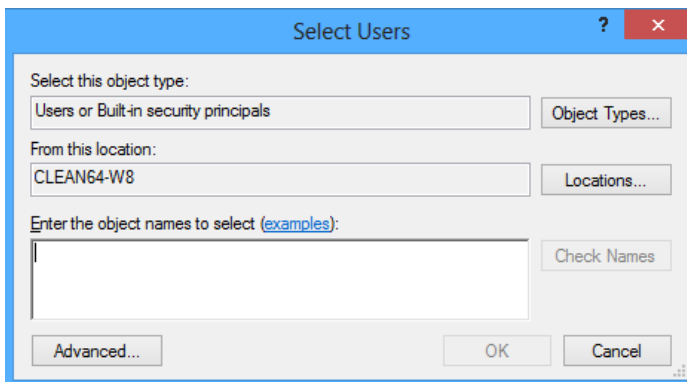

➔ To add a single user add their windows log in name and click Check Names

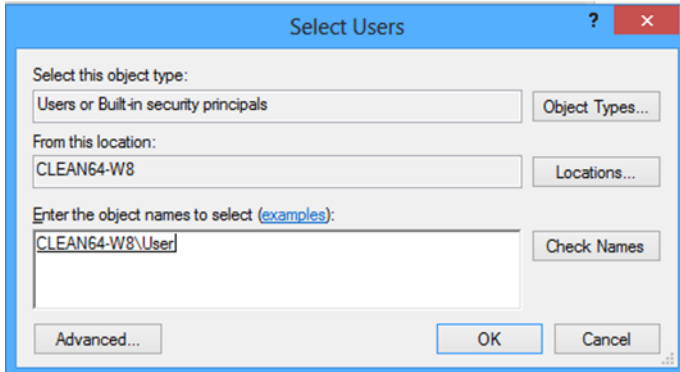

➔ Click Check Names

➔ Close Computer Management window

8 Run configuration Installation

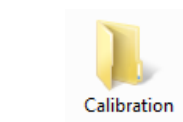

➔ Open the Calibration folder



➔ Double click on SetupCalibration

➔ Follow the on screen instructions

9 Run Protos 3 software

➔ Log on to the software and ensure the lights cycle Red, Blue and Green. Click on the image tab and select live image to ensure the camera produces a live image

Protos3 is now ready to be used

CONTACT SYNBIOSIS:
EUROPE:
Tel: +44 (0)1223 727125
Email: support@synbiosis.com

USA:
Tel: 800 686 4451/301 662 2863
Email: support@synbiosis.com

www.synbiosis.com
Protos3si0616